



[DBPR HOME](#) | [ABOUT DBPR](#) | [DBPR DIVISIONS](#) | [CONTACT DBPR](#)

[BCIS Home](#) | [Log In](#) | [User Registration](#) | [Hot Topics](#) | [Submit Surcharge](#) | [Stats & Facts](#) | [Publications](#) | [Contact Us](#) | [BCIS Site Map](#) | [Links](#) | [Search](#)



Product Approval
USER: Public User

[Product Approval Menu](#) > [Product or Application Search](#) > [Application List](#) > [Application Detail](#)

OFFICE OF THE SECRETARY

FL #	FL11968-R4						
Application Type	Revision						
Code Version	2017						
Application Status	Approved						
Comments							
Archived	<input type="checkbox"/>						
Product Manufacturer	Eastern Metal Supply						
Address/Phone/Email	4268 Westroads Drive West Palm Beach, FL 33407 (800) 432-2204 lrodriguez@easternmetal.com						
Authorized Signature	Bill Feeley lrodriguez@easternmetal.com						
Technical Representative							
Address/Phone/Email							
Quality Assurance Representative							
Address/Phone/Email							
Category	Shutters						
Subcategory	Storm Panels						
Compliance Method	Evaluation Report from a Florida Registered Architect or a Licensed Florida Professional Engineer <input type="checkbox"/> Evaluation Report - Hardcopy Received						
Florida Engineer or Architect Name who developed the Evaluation Report	Walter A. Tillit, Jr.						
Florida License	PE-44167						
Quality Assurance Entity	National Accreditation and Management Institute						
Quality Assurance Contract Expiration Date	12/31/2020						
Validated By	John Henry Kampmann Jr. <input checked="" type="checkbox"/> Validation Checklist - Hardcopy Received						
Certificate of Independence	FL11968 R4 COI EASTERN METAL SUPPLY, INC. DRAWING 17-098 CERTIFICATION OF INDEPENDENCE.PDF FL11968 R4 COI EASTERN METAL SUPPLY, INC. DRAWING 17-095 CERTIFICATION OF INDEPENDENCE.PDF FL11968 R4 COI EASTERN METAL SUPPLY, INC. DRAWING 17-096 CERTIFICATION OF INDEPENDENCE.PDF FL11968 R4 COI EASTERN METAL SUPPLY2c INC. DRAWING 17-094 CERTIFICATION OF INDEPENDENCE.pdf						
Referenced Standard and Year (of Standard)	<table border="0"> <thead> <tr> <th>Standard</th> <th>Year</th> </tr> </thead> <tbody> <tr> <td>ASTM E330</td> <td>2002</td> </tr> <tr> <td>SSTD12-99</td> <td>1999</td> </tr> </tbody> </table>	Standard	Year	ASTM E330	2002	SSTD12-99	1999
Standard	Year						
ASTM E330	2002						
SSTD12-99	1999						

Equivalence of Product Standards
Certified By

Florida Licensed Professional Engineer or Architect
[FL11968 R4 Equiv EASTERN METAL SUPPLY, INC. DRAWING 17-095 LETTER EQUIVALENCE BETWEEN SSTD 12-99 AND ASTM E-1996.PDF](#)
[FL11968 R4 Equiv EASTERN METAL SUPPLY, INC. DRAWING 17-098 LETTER OF EQUIVALENCE SSTD 12-99 AND ASTM E-1996.PDF](#)
[FL11968 R4 Equiv EASTERN METAL SUPPLY, INC DRAWING 17-096 LETTER EQUIVALENCE BETWEEN SSTD 12-99 AND ASTM E-1996.PDF](#)
[FL11968 R4 Equiv EASTERN METAL SUPPLY2c INC. DRAWING 17-094 LETTER EQUIVALENT BETWEEN SSTD 12-99 AND ASTM E-1996.pdf](#)

Sections from the Code

Product Approval Method Method 1 Option D

Date Submitted 09/20/2017
 Date Validated 10/28/2017
 Date Pending FBC Approval 10/29/2017
 Date Approved 12/12/2017

Summary of Products

FL #	Model, Number or Name	Description
11968.1	0.040" Bertha Aluminum Storm Panel (2.25" Deep)- Non-HVHZ - Drawing Number 17-094	Corrugated aluminum storm panels retained or not by tracks to provide hurricane protection.
Limits of Use Approved for use in HVHZ: No Approved for use outside HVHZ: Yes Impact Resistant: Yes Design Pressure: N/A Other: Large Missile. Max. span is 12'-0" for +25, -25 p.s.f. and 4'-0" for +125, -130 p.s.f. for sections 1, 3, 4, 6, 7, 8, 8A, 9 and 11. See sheet 10 of installation drawing for other spans and pressures. Valid only for wind zones 1,2 & 3 as defined by ASTM E-1996.		Installation Instructions FL11968 R4 II EASTERN METAL SUPPLY2c INC. DRAWING 17-094 0.040 BERTHA ALUMINUM STORM PANEL.pdf Verified By: American Test Lab of South Florida, Inc. Created by Independent Third Party: Yes Evaluation Reports FL11968 R4 AE EASTERN METAL SUPPLY2c INC. DRAWING 17-094 PRODUCT EVALUATION REPORT.pdf Created by Independent Third Party: Yes
11968.2	0.050" Bertha Aluminum Storm Panel (2.25" Deep)- Non-HVHZ - Drawing Number 17-096	Corrugated aluminum storm panels retained or not by tracks to provide hurricane protection.
Limits of Use Approved for use in HVHZ: No Approved for use outside HVHZ: Yes Impact Resistant: Yes Design Pressure: N/A Other: Large Missile. Max. span is 12'-11" for +30, -30 p.s.f. and 8'-2" for +75, -80 p.s.f. for mountings without "h" header. See sheet 5 of installation drawing for other spans and pressures. Valid only for wind zones 1,2 & 3 as defined by ASTM E-1996.		Installation Instructions FL11968 R4 II EASTERN METAL SUPPLY, INC. DRAWING 17-096 0.050 BERTHA ALUMINUM STORM PANEL.PDF Verified By: American Test Lab of South Florida, Inc. Created by Independent Third Party: Yes Evaluation Reports FL11968 R4 AE EASTERN METAL SUPPLY, INC. DRAWING 17-096 PRODUCT OF EVALUATION REPORT.PDF Created by Independent Third Party: Yes
11968.3	24 Gage Galvanized Bertha Steel Storm Panel (2.25" Deep)- Non-HVHZ - Drawing Number 17-095	corrugated galvanized steel storm panels retained or not by tracks to provide hurricane protection.
Limits of Use Approved for use in HVHZ: No Approved for use outside HVHZ: Yes Impact Resistant: Yes Design Pressure: N/A Other: Large Missile. Max. span is 9'-8" for +30, -40 p.s.f. and 7'-2" for +70, -80 p.s.f. for panels mounted without "H" header. See sheet 4 of installation drawing for other spans and pressures. Valid only for wind zones 1,2 & 3 as defined by ASTM E-1996.		Installation Instructions FL11968 R4 II EASTERN METAL SUPPLY, INC. DRAWING 17-095 24 GAGE GALVANIZE BERTHA STEEL STORM PANEL.PDF Verified By: American Test Lab of South Florida, Inc. Created by Independent Third Party: Yes Evaluation Reports FL11968 R4 AE EASTERN METAL SUPPLY, INC. DRAWING 17-095 PRODUCT EVALUATION REPORT.PDF Created by Independent Third Party: Yes

11968.4	Clear Bertha Storm Panels (2 1/4") - Drawing Number 17-098	corrugated polycarbonate storm panels retained or not by tracks to provide hurricane protection.
Limits of Use Approved for use in HVHZ: No Approved for use outside HVHZ: Yes Impact Resistant: Yes Design Pressure: N/A Other: Large Missile. Max/ span is 10'-0" for +28, -28 p.s.f. A.S.D. and 4'-0" for +105, -110 p.s.f. A.S.D desgin load. See sheet 3 of installation drawings for other spans and pressures. Valid only for wind zones 1,2 & 3 as defined by ASTM E-1996.		Installation Instructions FL11968 R4 II EASTERN METAL SUPPLY, INC. DRAWING 17-098 CLEAR BERTHA STORM PANEL 2.25.PDF Verified By: American Test Lab of South Florida, Inc. Created by Independent Third Party: Yes Evaluation Reports FL11968 R4 AE EASTERN METAL SUPPLY, INC. DRAWING 17-098 PRODUCT OF EVALUATION REPORT.PDF Created by Independent Third Party: Yes

[Back](#) [Next](#)

[Contact Us](#) :: 2601 Blair Stone Road, Tallahassee FL 32399 Phone: 850-487-1824

The State of Florida is an AA/EEO employer. [Copyright 2007-2013 State of Florida.](#) :: [Privacy Statement](#) :: [Accessibility Statement](#) :: [Refund Statement](#)

Under Florida law, email addresses are public records. If you do not want your e-mail address released in response to a public-records request, do not send electronic mail to this entity. Instead, contact the office by phone or by traditional mail. If you have any questions, please contact 850.487.1395. *Pursuant to Section 455.275 (1), Florida Statutes, effective October 1, 2012, licensees licensed under Chapter 455, F.S. must provide the Department with an email address if they have one. The emails provided may be used for official communication with the licensee. However email addresses are public record. If you do not wish to supply a personal address, please provide the Department with an email address which can be made available to the public. To determine if you are a licensee under Chapter 455, F.S., please click [here](#).

Product Approval Accepts:



Credit Card
Safe



GENERAL NOTES:

1. STORM PANEL SHOWN ON THIS PRODUCT EVALUATION DOCUMENT (P.E.D.) HAS BEEN VERIFIED FOR COMPLIANCE IN ACCORDANCE WITH THE 2017 (8th EDITION) OF THE FLORIDA BUILDING CODE. THIS STORM PANEL SHALL NOT BE INSTALLED AT HIGH VELOCITY HURRICANE ZONES (MMH-BLUE / BROWARD COUNTIES).

DESIGN WIND LOADS SHALL BE DETERMINED AS PER SECTION 1609 OF THE ABOVE MENTIONED CODE. FOR A WIND SPEED AS REQUIRED BY THE JURISDICTION WHERE THESE SHUTTERS WILL BE INSTALLED AND FOR A FREQUENCY FACTOR K=0.85, USING ASCE 7-10 FOR INSTALLATION UNDER 2017 IBC AND SHALL NOT EXCEED THE MAXIMUM (A.S.D.) DESIGN PRESSURE RATINGS INDICATED ON SHEETS 5 THRU 9. IN ORDER TO VERIFY THE ABOVE CONDITION, ULTIMATE DESIGN WIND LOADS DETERMINED PER ASCE 7-10 SHALL BE FIRST REDUCED TO A.S.D. DESIGN WIND LOADS BY MULTIPLYING THEM BY 0.6 IN ORDER TO COMPARE THESE W/ MAX. (A.S.D.) DESIGN PRESSURE RATINGS INDICATED ON SHEETS 5 THRU 9. IN ORDER TO VERIFY THAT COMPONENTS AND ANCHORS ON THIS P.E.D. AS TESTED WERE NOT OVER STRESSED, A 33% INCREASE IN ALLOWABLE STRESS FOR WIND LOADS WAS NOT USED IN THEIR ANALYSIS. A DURATION FACTOR CD=1.60 WAS USED FOR VERIFICATION OF FASTENERS IN WOOD.

STORM PANEL'S ADEQUACY FOR IMPACT AND FATIGUE RESISTANCE HAS BEEN VERIFIED IN ACCORDANCE WITH SECTION 1609.1.2 OF THE ABOVE MENTIONED CODE AS PER APT. REPORTS # 0121.01-98R, # 0329.01-02, # 0525.01-00 AND #0512.01-03 OF 6/05/17-02-04. USE PER IMPACT TESTING EQUIVALENT TO ASTM E-1996 STANDARD & ASTM E-330-02 STANDARD. TO BE INSTALLED WITHIN WIND ZONES 1, 2 & 3 AS DERIVED BY ASTM E-1996 STANDARD; AND #0221.01-01 PER TAB 201, 202 & 203.

2. ALL ALUMINUM SHEET METAL PANELS SHALL HAVE 5052-H32 OR 3004-H34 ALLOY.

3. ALL ALUMINUM EXTRUSIONS SHALL BE ALUMINUM ASSOCIATION 6063-T6 ALLOY & TEMPER UNLESS OTHERWISE NOTED. STORM PANEL COMPONENTS (A) STUDDED PLATE AND (B) SWAP OR ARE PRESENT PENDING.

4. ALL SCREWS TO BE STAINLESS STEEL 304 OR 316 AISI SERIES OF CORROSION RESISTANT COATED CARBON STEEL AS PER DM 50018 W/ 50 ksi YIELD STRENGTH AND 90 ksi TENSILE STRENGTH & SHALL COMPLY W/ FLORIDA BUILDING CODE SECTION 2417.3.3.4.

5. BOLTS TO BE ASTM A-307 GALVANIZED STEEL OR AISI 304 SERIES STAINLESS STEEL WITH 35 ksi MINIMUM YIELD STRENGTH.

6. ANCHORS TO WALL SHALL BE AS FOLLOWS: (UNLESS OTHERWISE NOTED)

- (A) TO EXISTING POURED CONCRETE:
 - 1/4" Ø TAPCON ANCHORS AS MANUFACTURED BY LITW. BUILDEX.
 - 1/4" Ø CF TAP-GRIP ANCHORS (BERTHA STUD-CON), AS MANUFACTURED BY TRU-FAST CORPORATION.
 - 1/4" Ø Z-MAC MALL ANCHORS AS MANUFACTURED BY POWER FASTENERS, INC.
 - 1/4" Ø x 7/8" CALK-IN ANCHORS OR ELOO male & female PANELMATE AS MANUFACTURED BY POWER FASTENERS, INC. AND ELOO CONSTRUCTION PRODUCTS, RESPECTIVELY.
 - 1/4" Ø x 3/4" ALL POINTS SOLID-SET ANCHORS AS DISTRIBUTED BY ALL POINTS SCREW, BOLT & SPECIALTY COMPANY, NOTES.
- (A.1) MINIMUM EMBEDMENT INTO POURED CONCRETE OF TAPCON ANCHORS IS 1 3/4" FOR Z-MAC MALL ANCHORS IS 1 3/8"; FOR ELOO PANELMATE ANCHORS IS 1 3/4" AND FOR CF TAP-GRIP ANCHORS IS 1 1/4".
- (A.2) 7/8" CALK-IN ANCHORS SHALL BE ENTIRELY EMBEDDED INTO THE POURED CONCRETE. NO EMBEDMENT INTO STUCCO SHALL BE PERMITTED. 1/4"-Ø-20 SCREWS USED SHALL BE 1 1/2" LONG MINIMUM SHOULD STUCCO EXIST, AND 1" MINIMUM FOR WALLS WITH NO STUCCO.
- (A.3) MINIMUM EMBEDMENT OF 1/4" Ø x 3/4" ALL POINTS SOLID-SET ANCHORS SHALL BE 7/8" INTO THE POURED CONCRETE. NO EMBEDMENT INTO STUCCO SHALL BE PERMITTED. 1/4" Ø-20 S.S. MACHINE SCREW USED SHALL BE 1 1/2" LONG MINIMUM SHOULD STUCCO EXIST AND 1" MINIMUM FOR WALLS WITH NO STUCCO.
- (A.4) IN CASE THAT PRECAST STONE, PRECAST CONCRETE PANELS, OR PARTS BE FOUND ON THE EXISTING WALL OR FLOOR, ANCHORS SHALL BE LONG ENOUGH TO REACH THE MAIN STRUCTURE BEHIND SUCH PANELS. ANCHORAGE SHALL BE AS INDICATED ON NOTES A.1) & A.2) ABOVE.

(B) TO EXISTING CONCRETE BLOCK WALL:

- 1/4" Ø TAPCON ANCHORS AS MANUFACTURED BY LITW. BUILDEX.
- 1/4" Ø CF TAP-GRIP ANCHORS (BERTHA STUD-CON), AS MANUFACTURED BY TRU-FAST CORPORATION.
- 1/4" Ø Z-MAC MALL ANCHORS AS MANUFACTURED BY POWER FASTENERS, INC.
- 1/4" Ø x 7/8" CALK-IN ANCHORS OR ELOO male & female PANELMATE AS MANUFACTURED BY POWER FASTENERS, INC. AND ELOO CONSTRUCTION PRODUCTS, RESPECTIVELY.
- 1/4" Ø x 3/4" ALL POINTS SOLID-SET ANCHORS AS DISTRIBUTED BY ALL POINTS SCREW, BOLT & SPECIALTY COMPANY.
- 1/4" Ø RED HEAD DYNABOLT SLEEVE ANCHORS AS MANUFACTURED BY LITW. BUILDEX.

NOTES:

B.1) MINIMUM EMBEDMENT OF TAPCON, ELOO PANELMATE AND CF TAP-GRIP ANCHORS INTO CONCRETE BLOCK UNIT SHALL BE 1 1/4" 1 3/8" FOR Z-MAC MALL ANCHORS AND 1 1/8" FOR RED HEAD DYNABOLT SLEEVE ANCHORS

B.2) 7/8" CALK-IN ANCHORS SHALL BE ENTIRELY EMBEDDED INTO THE CONCRETE BLOCK UNIT. NO EMBEDMENT INTO STUCCO SHALL BE PERMITTED. 1/4"-Ø-20 SCREWS USED SHALL BE 1 1/2" LONG MINIMUM SHOULD STUCCO EXIST, AND 1" MINIMUM FOR WALLS WITH NO STUCCO.

B.3) MINIMUM EMBEDMENT OF 1/4" Ø x 3/4" ALL POINTS SOLID-SET ANCHORS SHALL BE 7/8" INTO THE CONCRETE BLOCK. NO EMBEDMENT INTO STUCCO SHALL BE PERMITTED. 1/4" Ø-20 S.S. MACHINE SCREW USED SHALL BE 1 1/2" LONG MINIMUM SHOULD STUCCO EXIST, AND 1" MINIMUM FOR WALLS WITH NO STUCCO.

B.4) IN CASE THAT PRECAST STONE OR PRECAST CONCRETE PANELS BE FOUND ON THE EXISTING WALL, ANCHORS SHALL BE LONG ENOUGH TO REACH THE MAIN STRUCTURE BEHIND SUCH PANELS. ANCHORAGE SHALL BE AS INDICATED ON NOTES B.1) AND B.2) ABOVE.

(C) ANCHORS SHALL BE INSTALLED FOLLOWING ALL OF THE RECOMMENDATIONS AND SPECIFICATIONS OF THE ANCHOR'S MANUFACTURER.

7. PANELS MAY ALSO BE INSTALLED HORIZONTALLY FOLLOWING INSTALLATION DETAILS SHOWN ON SECTIONS 1 THRU 8 (SHEET 3 & 4 OF 7) EXCEPT THAT HEADERS 3, 4 & 5 SHALL NOT BE USED.

8. IT SHALL BE THE RESPONSIBILITY OF THE CONTRACTOR TO VERIFY THE SOUNDNESS OF THE STRUCTURE WHERE SHUTTER IS TO BE ATTACHED TO INSURE PROPER ANCHORAGE. THIS SHUTTER SHALL ONLY BE ATTACHED TO CONCRETE BLOCK OR WOOD TRIMME BUILDINGS.

9. THE INSTALLATION CONTRACTOR IS TO SEAL/CALK ALL SHUTTER COMPONENT EDGES WHICH REMAIN IN CONTINUOUS CONTACT WITH THE BUILDING TO PREVENT WIND/RAIN INTRUSION. CALK AND SEAL SHUTTER TRACKS ALL AROUND FULL LENGTH.

10. (a) THIS P.E.D. PREPARED BY THIS ENGINEER IS GENERIC AND DOES NOT PROVIDE INFORMATION FOR A SITE SPECIFIC PROJECT; i.e. WHERE THE SITE CONDITIONS DEVIATE FROM THE P.E.D.

(b) CONTRACTOR TO BE RESPONSIBLE FOR THE SELECTION, PURCHASE AND INSTALLATION INCLUDING LIFE SAFETY OF THIS PRODUCT. BASED ON THIS P.E.D. PROVIDED HE/SHE DOES NOT DEVIATE FROM THE CONDITIONS DETAILED ON THIS DOCUMENT. CONSTRUCTION SAFETY AT SITE IS THE CONTRACTOR'S RESPONSIBILITY.

(c) THIS P.E.D. WILL BE CONSIDERED INVALID IF ALTERED BY ANY MEANS.

(d) SITE SPECIFIC PROJECTS SHALL BE PREPARED BY A FLORIDA REGISTERED ENGINEER OR ARCHITECT WHICH WILL BECOME THE ENGINEER OF RECORD (E.O.R.) FOR THE PROJECT AND WHO WILL BE RESPONSIBLE FOR THE PROPER USE OF THE P.E.D. AS A DESIGNER, ACTING AS A DELEGATED ENGINEER TO THE P.E.D. ENGINEER, SHALL SUBMIT TO THIS LATTER THE SITE SPECIFIC ORDINANCES FOR REVIEW.

(e) THIS P.E.D. SHALL BEAR THE DATE AND ORIGINAL SEAL AND SIGNATURE OF THE PROFESSIONAL ENGINEER OF RECORD THAT PREPARED IT.

11. SHUTTER MANUFACTURER'S LABEL SHALL BE LOCATED ON A READILY VISIBLE LOCATION AT STORM PANEL IN ACCORDANCE WITH SECTION 1709.8.3 OF FLORIDA BUILDING CODE. ONE LABEL SHALL BE PLACED FOR EVERY OPENING. LABELING TO COMPLY WITH SECTION 1709.8.3 OF THE FLORIDA BUILDING CODE.



THIS DRAWING SHALL ONLY BE USED TO OBTAIN PERMITS IN THE STATE OF FLORIDA

FLORIDA BUILDING CODE (Non High Velocity Hurricane Zone)
0.050" BERTHA ALUMINUM STORM PANEL
(2.25" DEEP)

TILECO INC.
TILT TESTING & ENGINEERING COMPANY
4288 WEST ROAD, SUITE 100
PALM BEACH, FL 33407
PHONE: (561)209-8202 FAX: (561)941-1716

EASTERN METAL SUPPLY, INC
17-096
DATE: 02/26/17

REV.	DATE	BY	CHK.	DESCRIPTION
1	02/26/17			ISSUED FOR PERMIT
2	02/26/17			REVISED

DRAWING NO. SHEET 1 OF 14

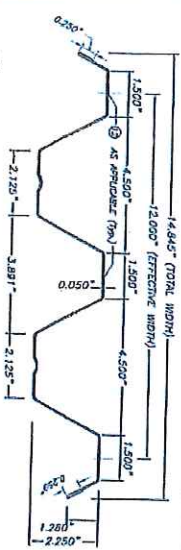

1 FULL ALUMINUM PANEL W/ HEMMED EDGES

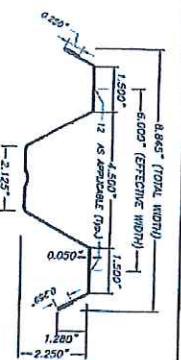

2 HALF ALUMINUM PANEL W/ HEMMED EDGES



3 3/4\"/>

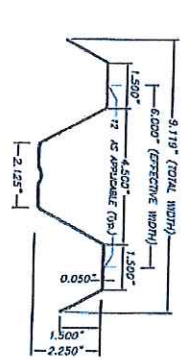

4 3\"/>

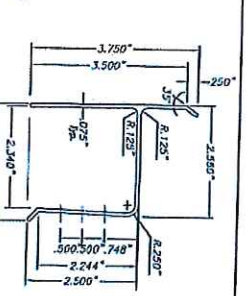

5 3/4\"/>

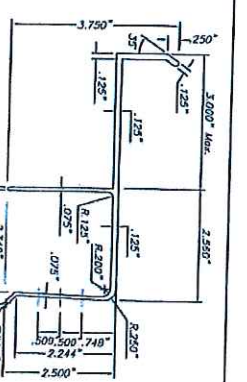

6 3\"/>

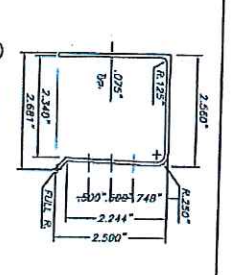

7 3/4\"/>

1 FULL ALUMINUM PANEL W/O HEMMED EDGES

2 HALF ALUMINUM PANEL W/O HEMMED EDGES

3 3\"/>

4 3\"/>

5 3/4\"/>

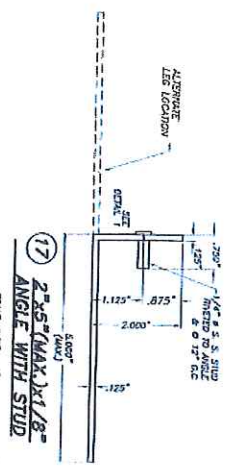

17 2\"/>

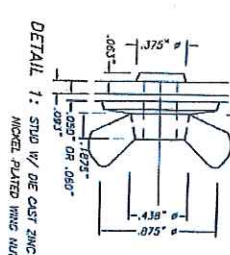

18 DETAIL 1: STUD W/ ONE CAST ZINC MODEL PLATED WIND NUT

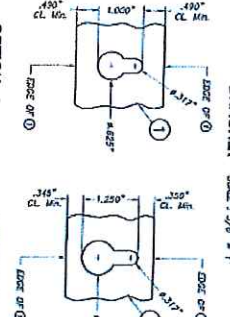

19 3\"/>

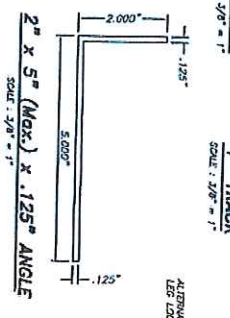

20 3/4\"/>



21 2\"/>

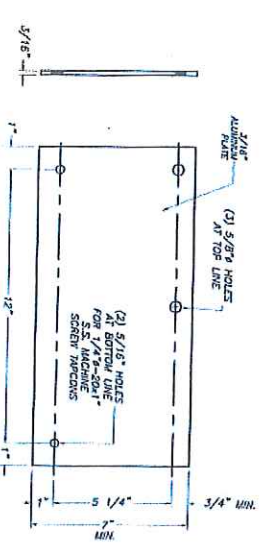

16 3/16\"/>

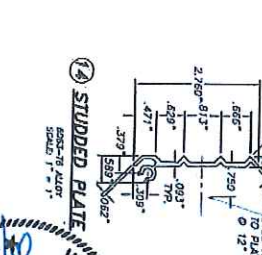

14 STUDDED PLATE

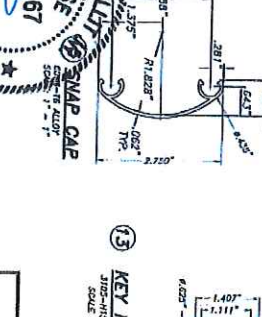

13 KEY HOLE WASHER

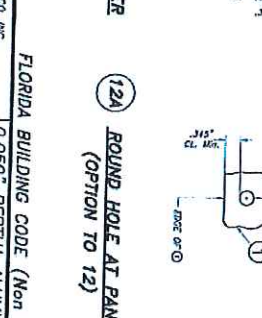

12a ROUND HOLE AT PANEL (OPTION TO 12)



10 STUDDED ANGLE



TILECO Inc.
 2307 TILECO, INC.
 FLORIDA BUILDING CODE (Non High Velocity Hurricane Zone)
 0.050\"/>

EASTERN METAL SUPPLY, INC.
 4288 WEST ROUNDS DRIVE
 WEST PALM BEACH, FL 33407
 PHONE: (561) 299-4200 FAX: (561) 941-1716
 17-096
 DRAWING BY: DATE: SHEET 14 OF 14

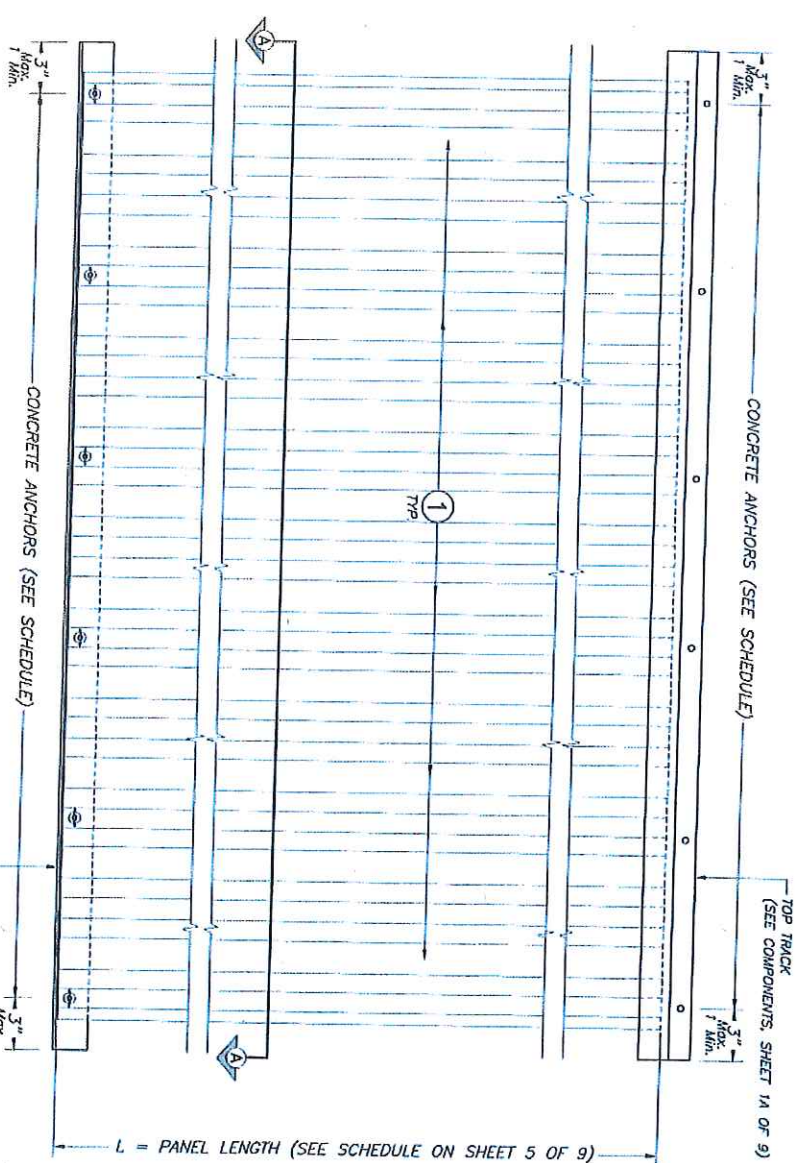

STORM PANEL TYPICAL ELEVATION

SCALE: 1/8" = 1"

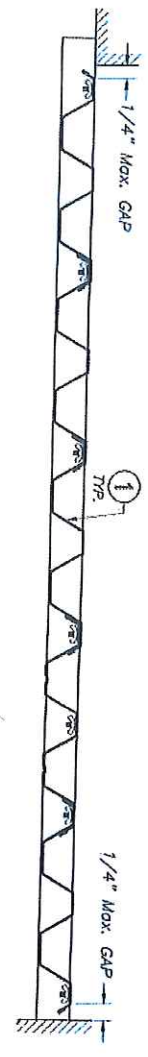

SECTION A-A

SCALE: 1/8" = 1"



©2017 TILTECO, INC.

TILTECO INC.

TILITZ TESTING & ENGINEERING COMPANY
 4305 N.W. 30th St. • DEERFIELD BEACH, FL 33447
 Phone: (561) 259-4262 Fax: (561) 259-4531
 Walter A. Tilitz, Jr., P.E.
 Florida Lic. # 44167

FLORIDA BUILDING CODE (Non High Velocity Hurricane Zone)
 0.050" BERTHA ALUMINUM STORM PANEL
 (2.25" DEEP)

EASTERN METAL SUPPLY, INC

4288 WEST ROADS DRIVE
 WEST PALM BEACH, FL 33407
 PHONE: (561) 259-4262 FAX: (561) 241-1716

REV. NO.	DESCRIPTION	DATE	BY	CHECKED	DATE
1	ISSUED	07/28/17			

17-096
DRAWING NO.

SHEET 2 OF 14

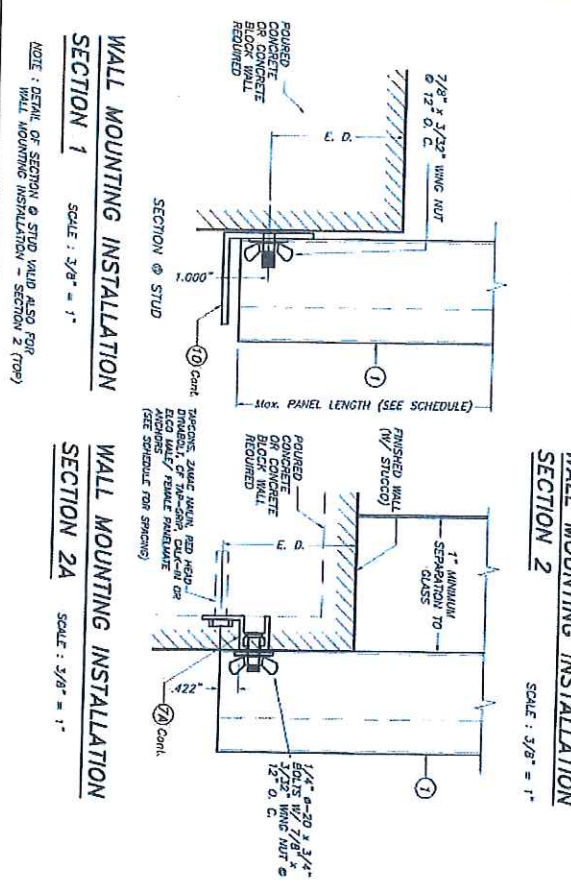
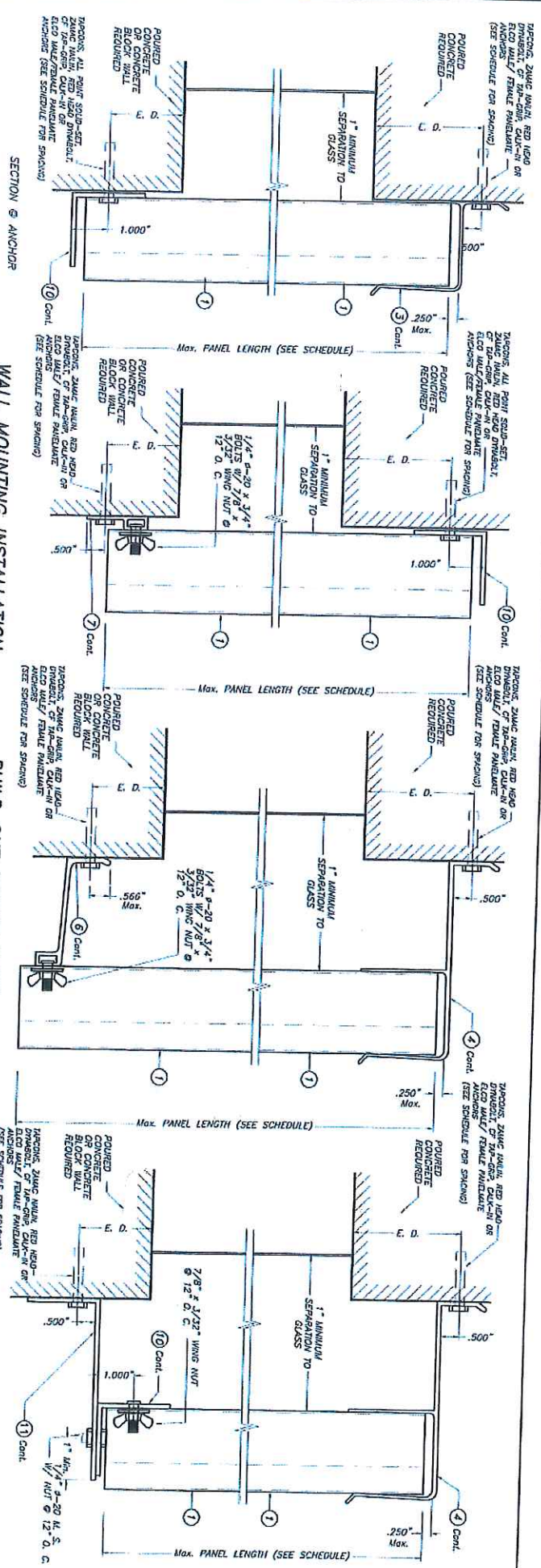

E. D. = EDGE DISTANCE (SEE SCHEDULE ON SHEETS 8 & 7)

NOTE FOR COMBINATION OF SECTIONS: WALL/FLOOR/CEILING MOUNTING SECTIONS CAN BE COMBINED IN ANY WAY TO SUIT ANY INSTALLATION.

©2017 TILTECO, INC.

TILTECO INC.

TILT TESTING & ENGINEERING COMPANY
 4268 WEST ROLDS DRIVE
 WEST PALM BEACH, FL 33407
 PHONE: (561)909-0263 FAX: (561)904-1715
 WWW.TILTECO.COM

FLORIDA BUILDING CODE (Non High Velocity Hurricane Zone)
 0.050" BERTHA ALUMINUM STORM PANEL
 (2.25" DEEP)

EASTERN METAL SUPPLY, INC

4268 WEST ROLDS DRIVE
 WEST PALM BEACH, FL 33407
 PHONE: (561)909-0263 FAX: (561)904-1715
 WWW.EASTERNMETAL.COM

REV. NO.	DESCRIPTION	DATE	BY	APPROVED
1	ISSUE FOR PERMIT	07/20/17	J	
2				

17-096
 DRAWING NO.
 SHEET 3 OF 14



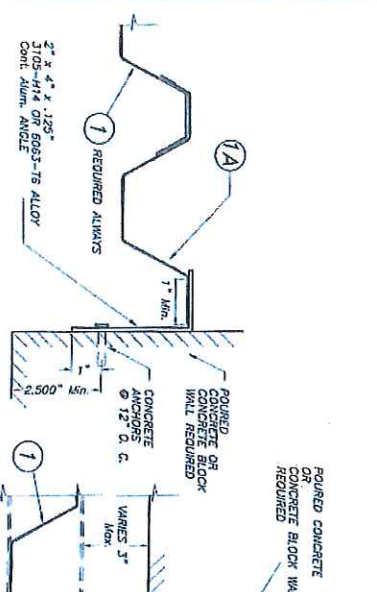

CASE A (Plan)
SCALE: 1/4" = 1"

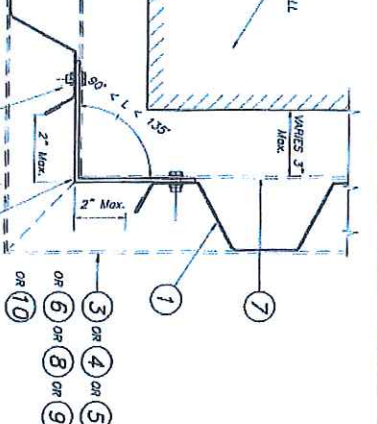

CASE B (Plan)
SCALE: 1/4" = 1"

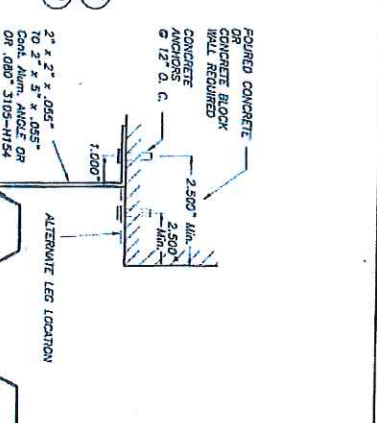

CASE C (Plan)
SCALE: 1/4" = 1"

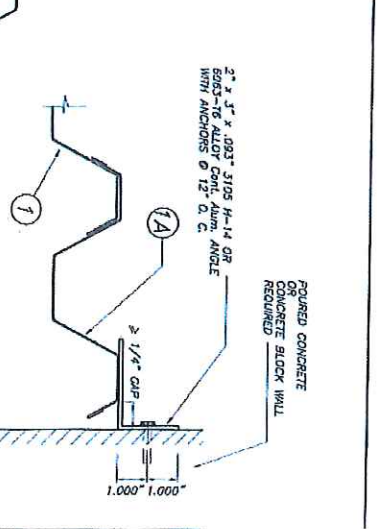

CASE D (Plan)
SCALE: 1/4" = 1"

MAXIMUM A.S.D. DESIGN PRESSURE RATING (P.S.F.) AND CORRESPONDING MAXIMUM PANEL LENGTH "L"
SCHEDULE FOR A GIVEN PANEL SYSTEM

MAXIMUM A.S.D. DESIGN PRESSURE RATING (P.S.F.)	HOUSING W/ 7/8" HEADER (1)	HOUSING W/ 1" HEADER (2)	WALL HOUSING W/ 1" COMPRESS (3) & (4)
+30.0, -30.0	12'-11"	12'-11"	12'-11"
+30.0, -35.0	12'-11"	12'-11"	12'-11"
+35.0, -40.0	12'-0"	12'-0"	12'-0"
+40.0, -45.0	11'-2"	11'-2"	11'-2"
+45.0, -50.0	10'-7"	10'-4"	10'-7"
+50.0, -55.0	10'-0"	9'-4"	10'-0"
+55.0, -60.0	9'-7"	8'-6"	9'-7"
+60.0, -65.0	9'-2"	7'-9"	9'-2"
+65.0, -70.0	8'-9"	7'-2"	8'-9"
+70.0, -75.0	8'-6"	6'-6"	8'-6"
+75.0, -80.0	8'-2"	6'-3"	8'-2"

NOTE: MINIMUM PANEL LENGTH IS 3'-0"

END CLOSURES DETAILS

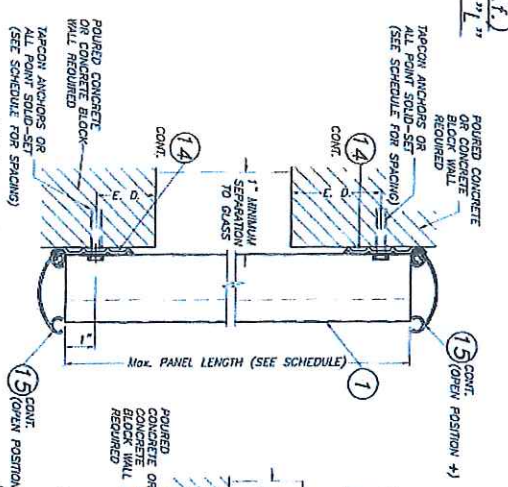

SECTION 9
SCALE: 3/8" = 1"

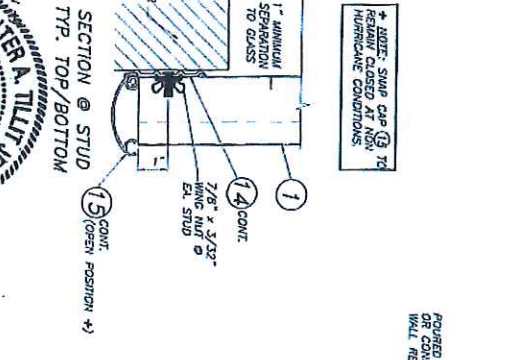

SECTION @ STUD
SCALE: 3/8" = 1"

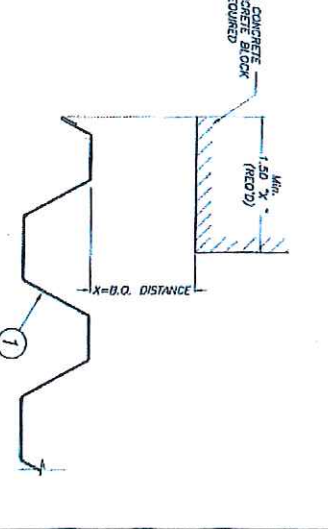

CASE E (Plan)
SCALE: 1/4" = 1"



FLORIDA BUILDING CODE (Non High Velocity Hurricane Zone)
0.050" BERTHA ALUMINUM STORM PANEL
(2.25" DEEP)

EASTERN METAL SUPPLY, INC.
4368 WEST ROADS DRIVE
WEST PALM BEACH, FL 33407
PHONE: (561) 269-8800 FAX: (561) 841-1716

DATE: 07/26/17
DRAWING NO: 17-096
SHEET 5 OF 14

THIS SCHEDULE INDICATES REQUIRED ANCHOR SPACING FOR A GIVEN A.S.D. DESIGN LOAD AND PANEL LENGTH. A.S.D. DESIGN LOAD MUST BE ENTERED AS PER SCHEDULE ON SHEET # 4.

MAXIMUM A.S.D. DESIGN PRESSURE RATING (P.s.f.) AND CORRESPONDING MAXIMUM ANCHOR SPACING SCHEDULE FOR INSTALLATIONS INTO CONCRETE AND CONCRETE BLOCK STRUCTURES *

E. D. = EDGE DISTANCE

MAXIMUM A.S.D. DESIGN PRESSURE RATING (P.s.f.)	MAXIMUM ANCHORS SPACING FOR E. D. = 3 1/2" **												APPLICABLE TO SECTION 4 & 5 ANY OTHER PANEL LENGTHS (IN)	MAXIMUM ANCHOR SPACING (IN)	
	TO	TO	TO	TO	TO	TO	TO	TO	TO	TO	TO	TO			
>+55.0, -80.0	12"	6"	12"	6"	12"	6"	12"	6"	12"	6"	12"	6"	12"	1 (TOP)	8'-0" OR LESS
	12"	6"	12"	6"	12"	6"	12"	6"	12"	6"	12"	6"	12"	1, 9" (BOTTOM)	
	12"	6"	12"	6"	12"	6"	12"	6"	12"	6"	12"	6"	12"	2, 9" (TOP)	
	12"	6"	12"	6"	12"	6"	12"	6"	12"	6"	12"	6"	12"	2 (BOTTOM)	
	12"	6"	12"	6"	12"	6"	12"	6"	12"	6"	12"	6"	12"	2A (BOTTOM)	
	12"	6"	12"	6"	12"	6"	12"	6"	12"	6"	12"	6"	12"	3 & 4 (TOP)	
	12"	6"	12"	6"	12"	6"	12"	6"	12"	6"	12"	6"	12"	3 (BOTTOM)	
	12"	6"	12"	6"	12"	6"	12"	6"	12"	6"	12"	6"	12"	4 (BOTTOM)	
	12"	6"	12"	6"	12"	6"	12"	6"	12"	6"	12"	6"	12"	5 (TOP)	
	12"	6"	12"	6"	12"	6"	12"	6"	12"	6"	12"	6"	12"	5 (BOTTOM)	
	12"	6"	12"	6"	12"	6"	12"	6"	12"	6"	12"	6"	12"	6 (TOP)	
	12"	6"	12"	6"	12"	6"	12"	6"	12"	6"	12"	6"	12"	6 (BOTTOM)	
>+55.0, -80.0	12"	6"	12"	6"	12"	6"	12"	6"	12"	6"	12"	6"	12"	7 (TOP)	8'-0" OR LESS
	12"	6"	12"	6"	12"	6"	12"	6"	12"	6"	12"	6"	12"	7 (BOTTOM)	
	12"	6"	12"	6"	12"	6"	12"	6"	12"	6"	12"	6"	12"	7 (TOP)	
	12"	6"	12"	6"	12"	6"	12"	6"	12"	6"	12"	6"	12"	7 (BOTTOM)	
	12"	6"	12"	6"	12"	6"	12"	6"	12"	6"	12"	6"	12"	7 (TOP)	
	12"	6"	12"	6"	12"	6"	12"	6"	12"	6"	12"	6"	12"	7 (BOTTOM)	
	12"	6"	12"	6"	12"	6"	12"	6"	12"	6"	12"	6"	12"	7 (TOP)	
	12"	6"	12"	6"	12"	6"	12"	6"	12"	6"	12"	6"	12"	7 (BOTTOM)	
	12"	6"	12"	6"	12"	6"	12"	6"	12"	6"	12"	6"	12"	7 (TOP)	
	12"	6"	12"	6"	12"	6"	12"	6"	12"	6"	12"	6"	12"	7 (BOTTOM)	
	12"	6"	12"	6"	12"	6"	12"	6"	12"	6"	12"	6"	12"	7 (TOP)	
	12"	6"	12"	6"	12"	6"	12"	6"	12"	6"	12"	6"	12"	7 (BOTTOM)	

MAXIMUM A.S.D. DESIGN PRESSURE RATING (P.s.f.)	MAXIMUM ANCHORS SPACING FOR E. D. = 3 1/2" **												APPLICABLE TO SECTION 4 & 5 ANY OTHER PANEL LENGTHS (IN)	MAXIMUM ANCHOR SPACING (IN)	
	TO	TO	TO	TO	TO	TO	TO	TO	TO	TO	TO	TO			
>+55.0, -80.0	12"	6"	12"	6"	12"	6"	12"	6"	12"	6"	12"	6"	12"	1 (TOP)	8'-0" OR LESS
	12"	6"	12"	6"	12"	6"	12"	6"	12"	6"	12"	6"	12"	1, 9" (BOTTOM)	
	12"	6"	12"	6"	12"	6"	12"	6"	12"	6"	12"	6"	12"	2, 9" (TOP)	
	12"	6"	12"	6"	12"	6"	12"	6"	12"	6"	12"	6"	12"	2 (BOTTOM)	
	12"	6"	12"	6"	12"	6"	12"	6"	12"	6"	12"	6"	12"	2A (BOTTOM)	
	12"	6"	12"	6"	12"	6"	12"	6"	12"	6"	12"	6"	12"	3 & 4 (TOP)	
	12"	6"	12"	6"	12"	6"	12"	6"	12"	6"	12"	6"	12"	3 (BOTTOM)	
	12"	6"	12"	6"	12"	6"	12"	6"	12"	6"	12"	6"	12"	4 (BOTTOM)	
	12"	6"	12"	6"	12"	6"	12"	6"	12"	6"	12"	6"	12"	5 (TOP)	
	12"	6"	12"	6"	12"	6"	12"	6"	12"	6"	12"	6"	12"	5 (BOTTOM)	
	12"	6"	12"	6"	12"	6"	12"	6"	12"	6"	12"	6"	12"	6 (TOP)	
	12"	6"	12"	6"	12"	6"	12"	6"	12"	6"	12"	6"	12"	6 (BOTTOM)	
>+55.0, -80.0	12"	6"	12"	6"	12"	6"	12"	6"	12"	6"	12"	6"	12"	7 (TOP)	8'-0" OR LESS
	12"	6"	12"	6"	12"	6"	12"	6"	12"	6"	12"	6"	12"	7 (BOTTOM)	
	12"	6"	12"	6"	12"	6"	12"	6"	12"	6"	12"	6"	12"	7 (TOP)	
	12"	6"	12"	6"	12"	6"	12"	6"	12"	6"	12"	6"	12"	7 (BOTTOM)	
	12"	6"	12"	6"	12"	6"	12"	6"	12"	6"	12"	6"	12"	7 (TOP)	
	12"	6"	12"	6"	12"	6"	12"	6"	12"	6"	12"	6"	12"	7 (BOTTOM)	
	12"	6"	12"	6"	12"	6"	12"	6"	12"	6"	12"	6"	12"	7 (TOP)	
	12"	6"	12"	6"	12"	6"	12"	6"	12"	6"	12"	6"	12"	7 (BOTTOM)	
	12"	6"	12"	6"	12"	6"	12"	6"	12"	6"	12"	6"	12"	7 (TOP)	
	12"	6"	12"	6"	12"	6"	12"	6"	12"	6"	12"	6"	12"	7 (BOTTOM)	
	12"	6"	12"	6"	12"	6"	12"	6"	12"	6"	12"	6"	12"	7 (TOP)	
	12"	6"	12"	6"	12"	6"	12"	6"	12"	6"	12"	6"	12"	7 (BOTTOM)	

ACTUAL E. D.	FACTOR			
	WAGON	ZIANG WALL/ RED HD. DIVERBOLT	CLIK-IN	SOLID-SET
3"	-.86	.75	.78	1.00
2 1/2"	-.71	.50	-.80	-.80
2"	-.50	-.50	-.50	-.50
1 1/2"	-.35	-.35	-.35	-.35

ONLY TOP/ROW ANCHORS OR ALL ROW SOLID-SET ALLOWED FOR MOUNTING SECTION 9. ANCHORS SPACING ONLY APPLICABLE TO ZIANG WALL ANCHORS BUILDINGS. SEE SHEET 7 & 8 FOR ANCHORS TYPE & SPACING FOR INSTALLATIONS INTO WOOD FRAME BUILDINGS. MAXIMUM ANCHOR SPACINGS ARE VALID FOR 3 1/2" EDGE DISTANCE. FOR E. D. LESS THAN 3 1/2", REDUCE ANCHOR SPACING BY MULTIPLYING SPACINGS SHOWN ON SCHEDULE BY THE FOLLOWING FACTORS: (Min. E. D. FOR CLIK-IN ANCHORS & ELDO PANELS IS 2 1/2", AND 3 1/2" FOR SOLID-SET ANCHORS). REDUCE ORDERING TO BE MADE REDUCED SPACINGS RESULTING FROM APPLYING ABOVE FACTORS SHALL NOT RESULT ON SPACINGS LESS THAN 3" FOR ALL ANCHORS (EXCEPT 4x5" FOR RED HD. DIVERBOLT ANCHORS).

FLORIDA BUILDING CODE (Non High Velocity Hurricane Zone)
0.050" BERTHA ALUMINUM STORM PANEL
(2.25" DEEP)

TILETECO Inc.
2017 TILETECO, INC.
4558 WEST ROUNDS DRIVE
WEST PALM BEACH, FL 33407
PHONE: (561) 869-8683 FAX: (561) 941-1716

EASTERN METAL SUPPLY, INC.
17-096
DRAWING NO.
SHEET 7 OF 14

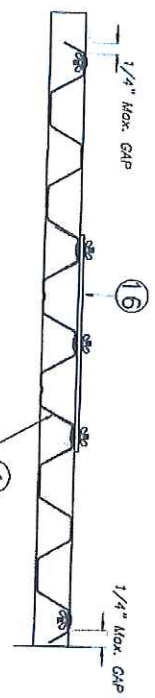

SECTION B-B
SCALE: 1/8" = 1"

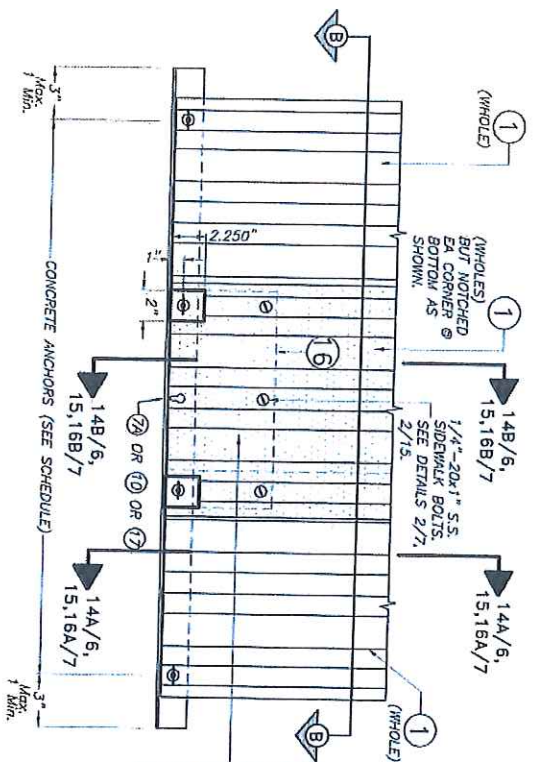

**INTERIORLY REMOVABLE STORM PANEL
PARTIAL ELEVATION Y**

SCALE: 1/8" = 1"

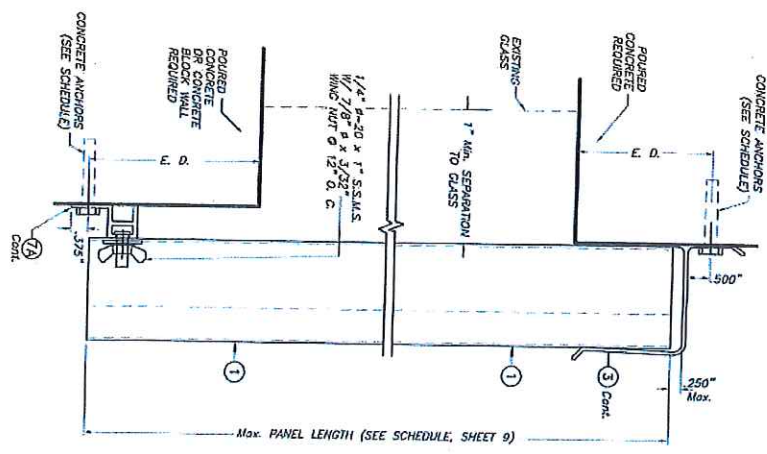
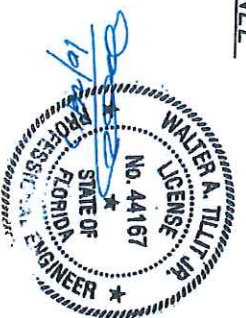

SECTION 10A

**WALL MOUNTING INSTALLATIONS
SECTIONS 10**

SCALE: 5/8" = 1"

**INSTALLATIONS VALID FOR PANELS ① USED JOINTLY
WITH INTERIORLY REMOVABLE PANELS ①**

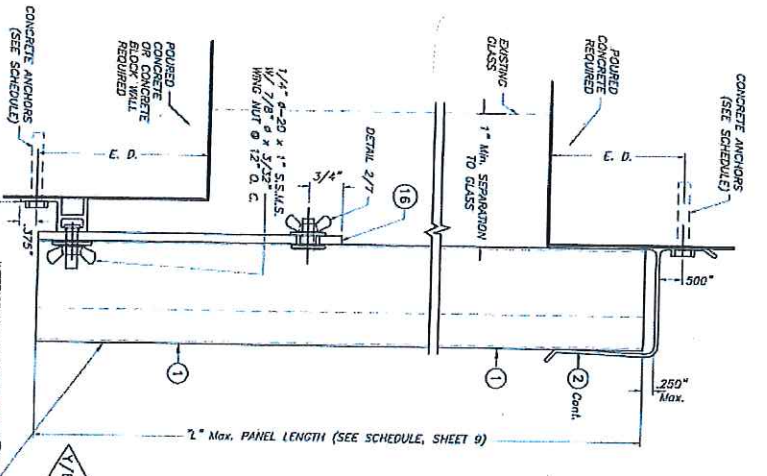

SECTION 10B

FLORIDA BUILDING CODE (Non High Velocity Hurricane Zone)
0.050" BERTHA ALUMINUM STORM PANEL
(2.25" DEEP)

TILECO Inc.
23017 TILECO, INC.
TULLIT TESTING & ENGINEERING COMPANY
1400 W. UNIVERSITY BLVD., SUITE 100
GAINESVILLE, FL 32607
TEL: (352) 339-4353 FAX: (352) 339-4353
E-mail: tileco@tillitt.com

EASTERN METAL SUPPLY, INC.
4328 WEST ROAD SW
WEST PALM BEACH, FL 33407
PHONE: (561) 209-8262 FAX: (561) 984-1716

REV.	DATE	BY	CHK.	DESCRIPTION
1	02/27/01	J		

DATE: 07/26/17
DRAWING NO. 17-096
SHEET 8 OF 14

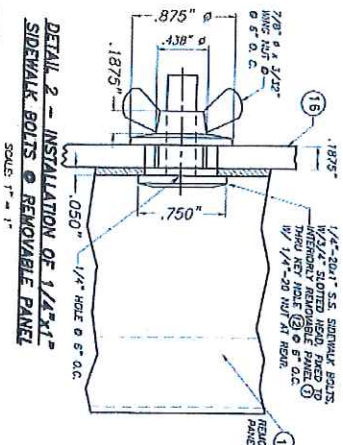
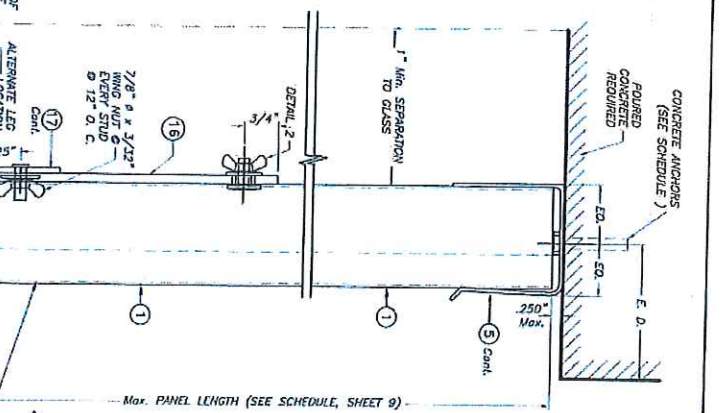
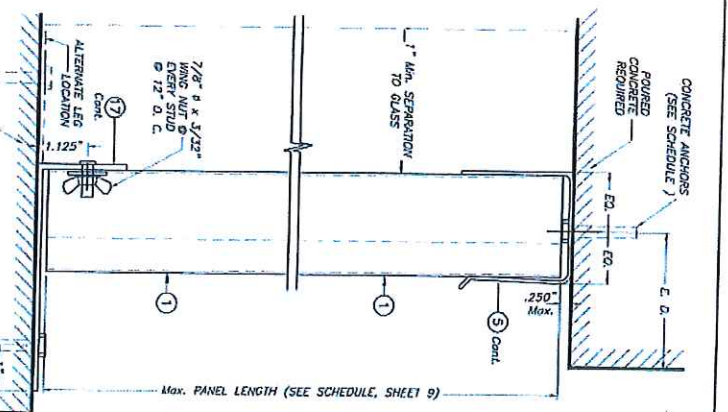
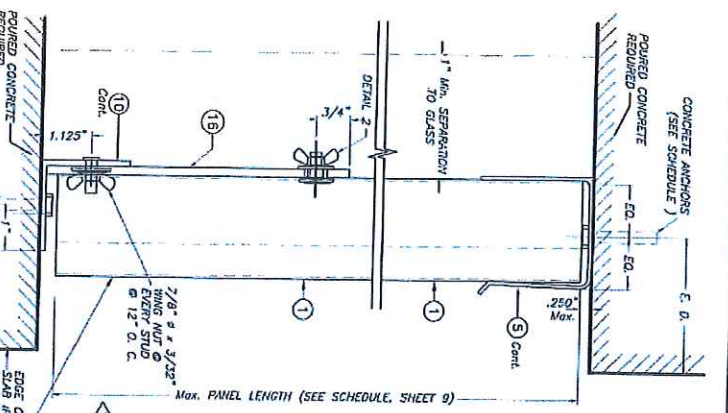
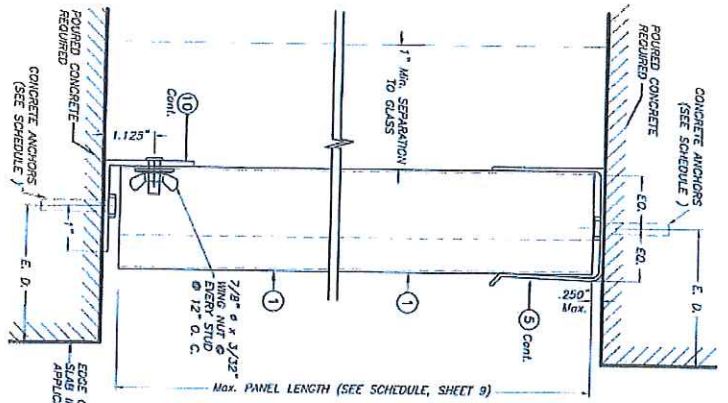

SECTION 11A
CEILING & FLOOR MOUNTING INSTALLATIONS
SECTIONS 11
 SCALE: 3/8" = 1"

SECTION 11B
CEILING & FLOOR MOUNTING INSTALLATIONS
SECTIONS 11
 SCALE: 3/8" = 1"

SECTION 12A
CEILING & FLOOR MOUNTING INSTALLATIONS
SECTIONS 12
 SCALE: 3/8" = 1"

SECTION 12B
CEILING & FLOOR MOUNTING INSTALLATIONS
SECTIONS 12
 SCALE: 3/8" = 1"

INSTALLATIONS VALID FOR PANELS ① USED JOINTLY WITH INTERIORLY REMOVABLE PANELS ②

NOTE FOR COMBINATION OF SECTIONS:
 FLOOR/CEILING MOUNTING SECTIONS CAN BE COMBINED IN ANY WAY TO SUIT ANY INSTALLATION.

E. D. = EDGE DISTANCE (SEE SCHEDULE ON SHEET 10 & 11)



TILECO INC.
 2017 TILECO, INC.
 FLORIDA BUILDING CODE (Non High Velocity Hurricane Zone)
 0.050" BERTHA ALUMINUM STORM PANEL (2.25" DEEP)

EASTERN METAL SUPPLY, INC.
 4298 WEST RUDAS DRIVE
 WEST PALM BEACH, FL 33407
 PHONE: (561) 269-0233 FAX: (561) 984-1715

REV. NO.	DATE	BY	CHK. BY
1	02/20/12		
2	02/20/12		

DRWING SH. 07/26/17
 DATE: 17-096
 DRAWING NO. SHEET 9 OF 14

MAXIMUM A.S.D. DESIGN PRESSURE RATING (p.s.f.) AND CORRESPONDING MAXIMUM ANCHOR SPACING SCHEDULE FOR INSTALLATIONS IN CONCRETE AND CONCRETE BLOCK STRUCTURES

MAXIMUM ANCHOR SPACING (p.s.f.)	MAXIMUM ANCHOR SPACING FOR E. D. = 3 1/2" ±											
	REGULAR TYPON	CRETE-FLEX SS4	ZALAC MESH	CLK-IN	CF 100-GRP	CF 100-GRP	CF 100-GRP	CF 100-GRP	CF 100-GRP	CF 100-GRP	CF 100-GRP	CF 100-GRP
12"	N/A	12"	N/A	12"	N/A	12"	N/A	12"	N/A	12"	N/A	12"
12"	4"	12"	10"	N/A	N/A	12"	9"	N/A	N/A	12"	N/A	12"
12"	N/A	12"	7"	N/A	N/A	12"	6 1/2"	N/A	N/A	12"	6"	12"
11 1/2"	N/A	12"	N/A	N/A	N/A	12"	N/A	N/A	N/A	12"	5 1/2"	12"
8 1/2" - 6.5"	N/A	12"	N/A	N/A	N/A	7 1/2"	N/A	N/A	N/A	12"	N/A	12"
N/A	N/A	12"	N/A	N/A	N/A	N/A	N/A	N/A	N/A	11 1/2"	N/A	11"
11 1/2"	N/A	12"	N/A	N/A	N/A	12"	N/A	N/A	N/A	12"	N/A	12"
8 1/2"	N/A	12"	N/A	N/A	N/A	12"	N/A	N/A	N/A	12"	N/A	12"
11 1/2"	N/A	12"	N/A	N/A	N/A	12"	N/A	N/A	N/A	12"	N/A	12"
8 1/2"	N/A	12"	N/A	N/A	N/A	12"	N/A	N/A	N/A	12"	N/A	12"
3"	N/A	12"	N/A	N/A	N/A	12"	N/A	N/A	N/A	12"	N/A	12"

E. D. = EDGE DISTANCE

* LIMITED TO 5'-4" MAX. SPAN.

ACTUAL E. D.	REGULAR TYPON & 410 S.S. TYPON	ZALAC MESH, CRETE-FLEX SS4 & PANELMATE OR PANELMATE PLUS	CLK-IN	SOLO-SET	CF 100-GRP
3"	-	.66	.75	.78	1.00
2 1/2"	-	.71	.80	-	.80
2"	-	.80	-	-	-
1 1/2"	0.35	-	-	-	-

ANCHOR TYPE	MIN. ANCHOR SPACING
410 S.S. TYPON, ZALAC MESH, CRETE-FLEX SS4, PANELMATE OR PANELMATE PLUS	3.0"
CLK-IN	3.5"
SOLO-SET	3.5"
CRETE FLEX SS4	6.0"
REGULAR TYPON IN BLOCK	4.0"
REGULAR TYPON IN CONCRETE	3.0"



©2017 TILTECO, INC.

TILTECO INC.

TILTIT TESTING & ENGINEERING COMPANY
4330 N.W. 35th St., Suite 200, West Palm Beach, FL 33418
Phone: (561) 909-8633, Fax: (561) 981-1531
E-mail: info@tilteco.com

FLORIDA BUILDING CODE (Non High Velocity Hurricane Zone)
0.050" BERTHA ALUMINUM STORM PANEL
(2.25" DEEP)

EASTERN METAL SUPPLY, INC.

4284 WESTGATE DRIVE
WEST PALM BEACH, FL 33411
PHONE: (561) 909-8633, FAX: (561) 981-1716

REV. NO.	DATE	DESCRIPTION
1	07/28/17	DATE
2		

DRAWING NO. 17-096
SHEET 10 OF 14

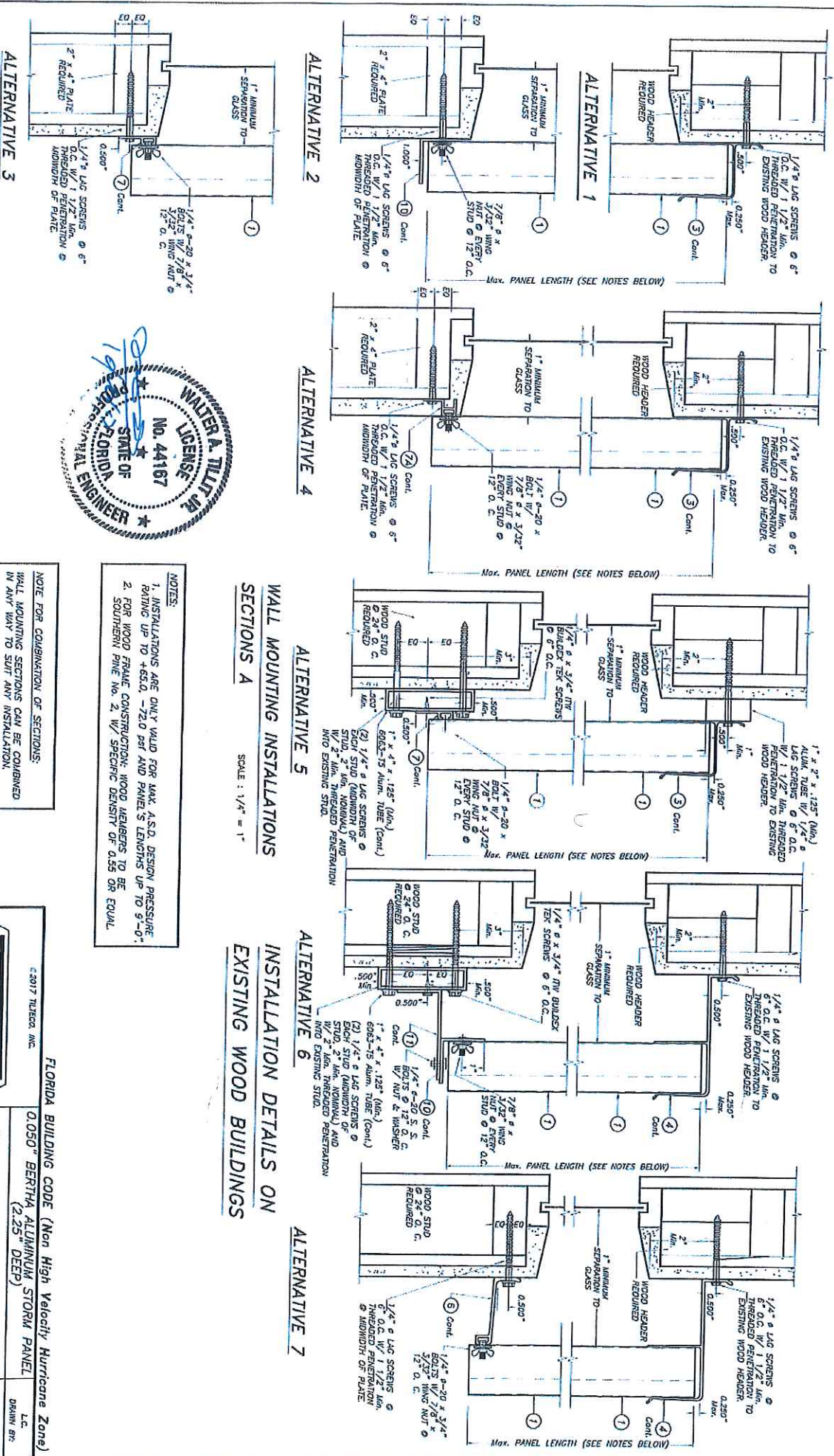

WALL MOUNTING INSTALLATIONS
SECTIONS A

SCALE: 1/4" = 1"

INSTALLATION DETAILS ON
EXISTING WOOD BUILDINGS

- NOTES:**
1. INSTALLATIONS ARE ONLY VALID FOR MAX. A.S.D. DESIGN PRESSURE RATING UP TO +63.0, -72.0 Dst AND PANEL LENGTHS UP TO 9'-0".
 2. FOR WOOD FRAME CONSTRUCTION: WOOD MEMBERS TO BE SOUTHERN PINE No. 2 W/ SPECIFIC DENSITY OF 0.55 OR EQUAL.

NOTE FOR COMBINATION OF SECTIONS:
 WALL MOUNTING SECTIONS CAN BE COMBINED IN ANY WAY TO SUIT ANY INSTALLATION.

FLORIDA BUILDING CODE (Non High Velocity Hurricane Zone)
 0.050" BERTHA ALUMINUM STORM PANEL
 (2.25" DEEP)

TILTECO INC.
 TILTUP TESTING & ENGINEERING COMPANY
 4288 WEST ROADS DRIVE
 WEST PALM BEACH, FL 33407
 PHONE: (561) 299-8281 FAX: (561) 541-1715

EASTERN METAL SUPPLY, INC
 17-096

REV. NO.	DATE	BY	CHKD.	DESCRIPTION
1	02/25/10	J		
2	02/25/10	J		

DRAWING No. 17-096
 SHEET 11 OF 14

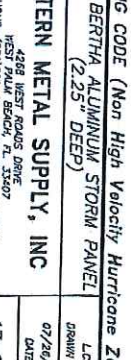
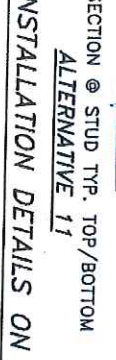
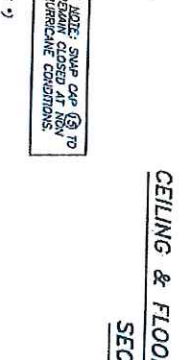
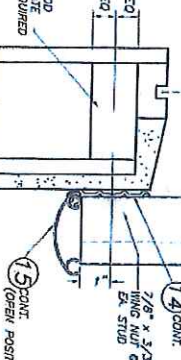
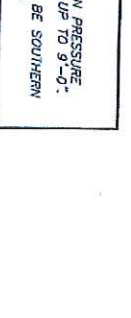
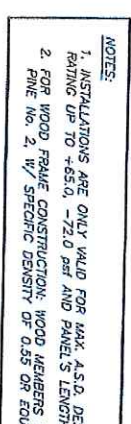
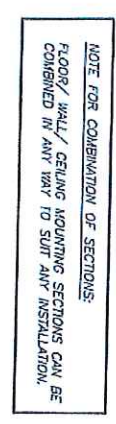
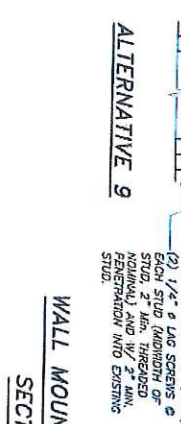
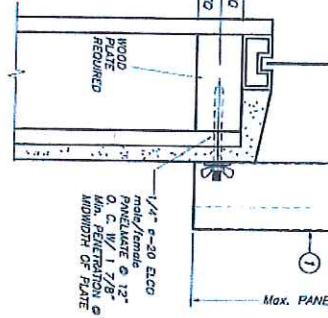
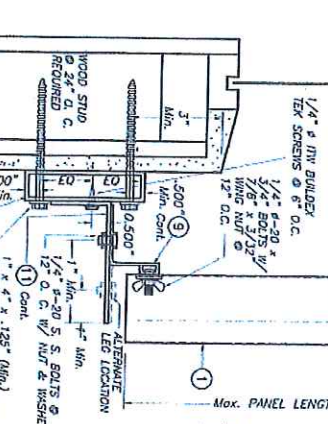
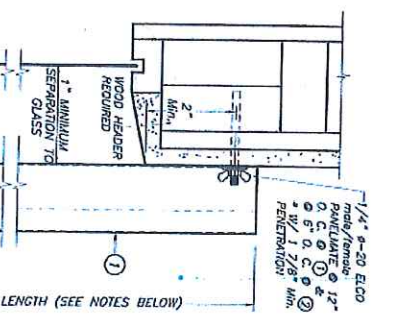
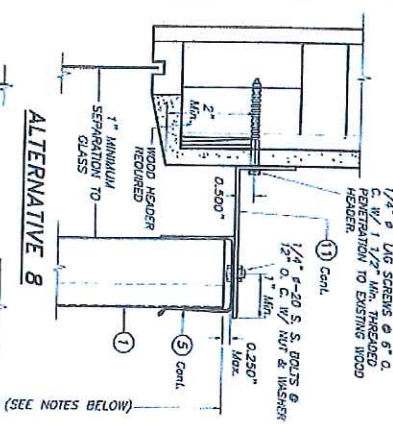

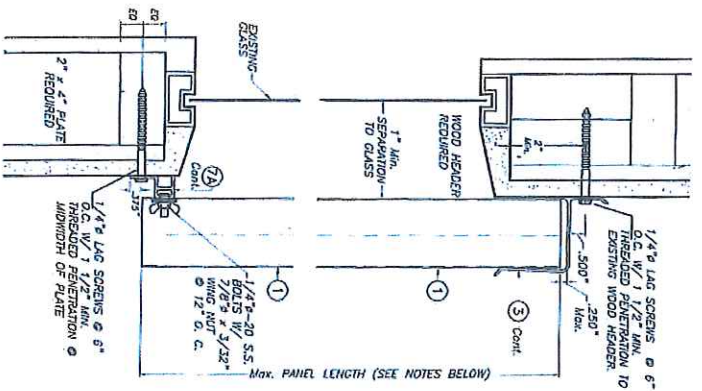

ALTERNATIVE 12A *

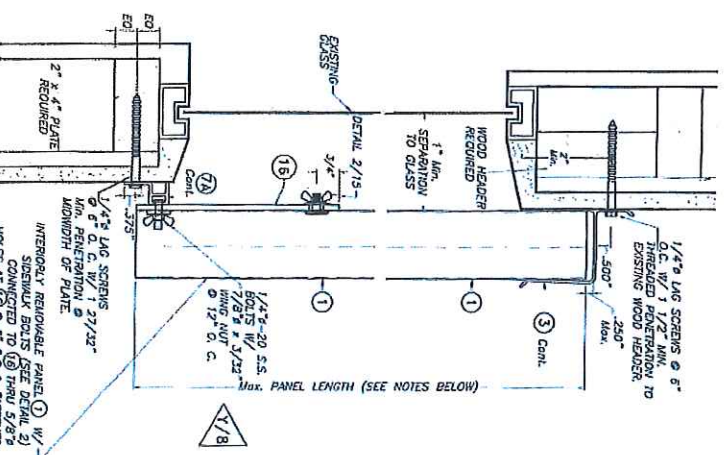

ALTERNATIVE 12B *

WALL MOUNTING INSTALLATIONS
 SECTIONS 12 * VALID FOR Max. +63.5, -63.5 psf.
 SCALE: 1/4" = 1' A.S.D. DESIGN PRESSURE RATING.

INSTALLATIONS VALID FOR PANELS ① USED JOINTLY
 WITH INTERIORLY REMOVABLE PANELS ②

INSTALLATION DETAILS ON EXISTING WOOD BUILDINGS



©2017 TILTECO, INC.
TILTECO INC.
 TILLIT TESTING & ENGINEERING COMPANY
 4208 WEST PALM BEACH BLVD.
 WEST PALM BEACH, FL 33407
 PHONE: (561)200-8253 FAX: (561)941-1716
 WALTER A. TILLITT, P.E.
 FLORIDA LIC. # 44167

FLORIDA BUILDING CODE (Non High Velocity Hurricane Zone)
 0.050" BERTHA ALUMINUM STORM PANEL
 (2.25" DEEP)

EASTERN METAL SUPPLY, INC.
 4208 WEST PALM BEACH BLVD.
 WEST PALM BEACH, FL 33407
 PHONE: (561)200-8253 FAX: (561)941-1716

17-096
 DRAWING No.

REV.	DATE	BY	CHK.	DESCRIPTION
1	07/26/17			

SHEET 13 OF 14

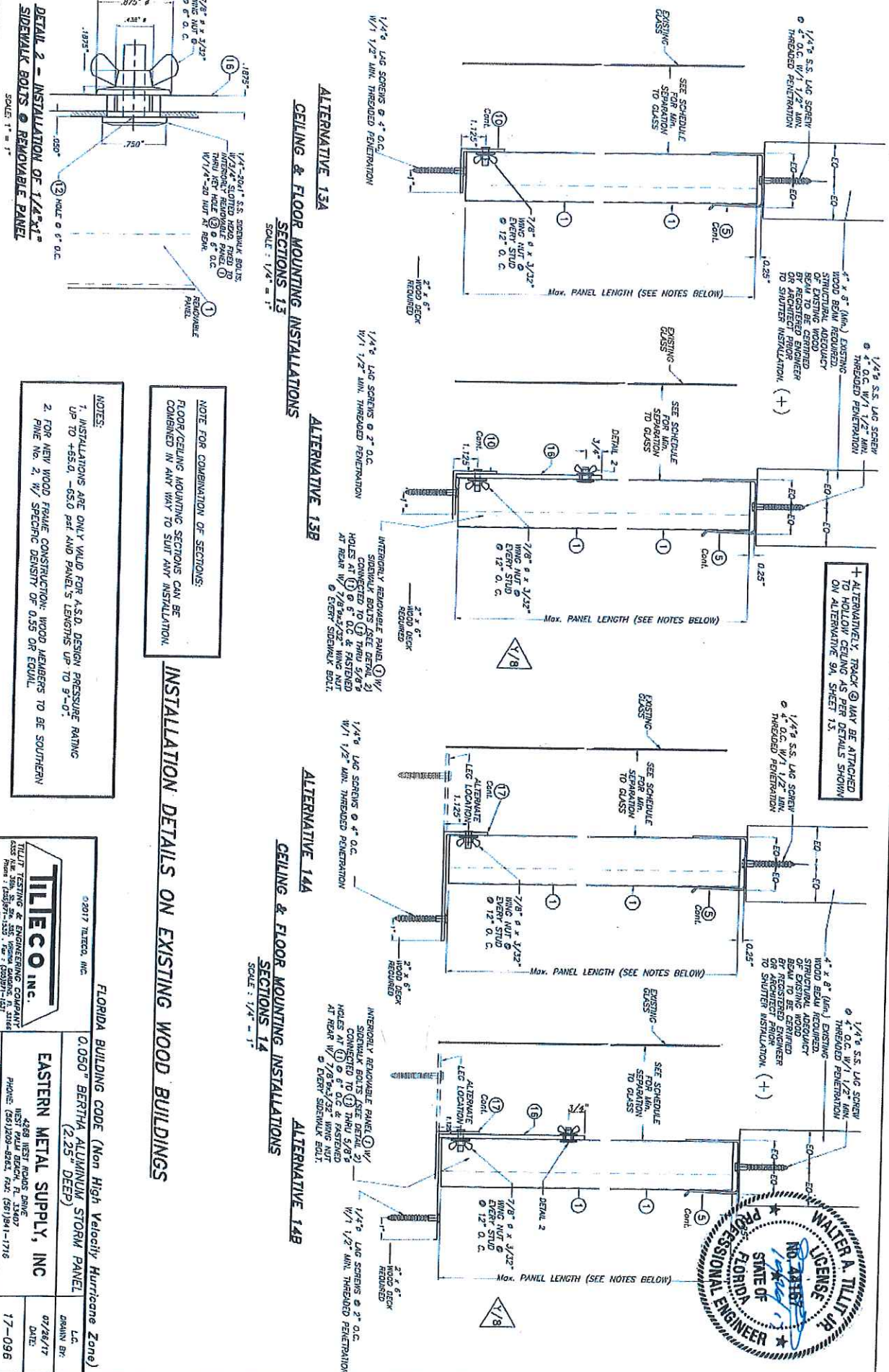

+ ALTERNATIVELY, TRACK (3) MAY BE ATTACHED TO HOLLOW CEILING AS PER DETAILS SHOWN ON ALTERNATIVE 9A, SHEET 13.

NOTE FOR COMBINATION OF SECTIONS:
 FLOOR/CEILING MOUNTING SECTIONS CAN BE COMBINED IN ANY WAY TO SUIT ANY INSTALLATION.

NOTES:
 1. INSTALLATIONS ARE ONLY VALID FOR A.S.D. DESIGN PRESSURE RATING UP TO +65.0, -65.0 psf AND PANEL'S LENGTHS UP TO 3'-0".
 2. FOR NEW WOOD FRAME CONSTRUCTION, WOOD MEMBERS TO BE SOUTHERN PINE No. 2, W/ SPECIFIC DENSITY OF 0.58 OR EQUAL.

INSTALLATION DETAILS ON EXISTING WOOD BUILDINGS

FLORIDA BUILDING CODE (Non High Velocity Hurricane Zone)
 0.050" BERTHA ALUMINUM STORM PANEL
 (2.25" DEEP)

TILTECO INC.
 4288 WEST ROLDS DRIVE
 WEST PALM BEACH, FL 33407
 PHONE: (561) 969-4848 FAX: (561) 964-1716

EASTERN METAL SUPPLY, INC
 17-096
 DRAWING NO.

REV.	DESCRIPTION	DATE	BY	CHECKED	DATE
1	ISSUED	02/25/13	J		
2					

02/28/17
 17-096
 SHEET 14 OF 14